



Relocatable MR Cassette Mini Clinics

Want the speed, simplicity, flexibility and beauty of the Cassette – but need more space? Consider the Cassette Mini Clinic, designed to your specifications.

You choose the size and design – we'll deliver your relocatable Mini Clinic to have you serving patients in the shortest time-frame possible.

Plus, if plans change – so can your Mini Clinic.

Begin your architectural planning process today for your permanent building. Take delivery of your own "fixed site" MRI system in a spacious building. Simply "transplant" your MRI system into your completed construction and redeploy or sell the Cassette building. How more "lean" and cost effective can it be to bring tomorrow's MRI technology to your patients today!

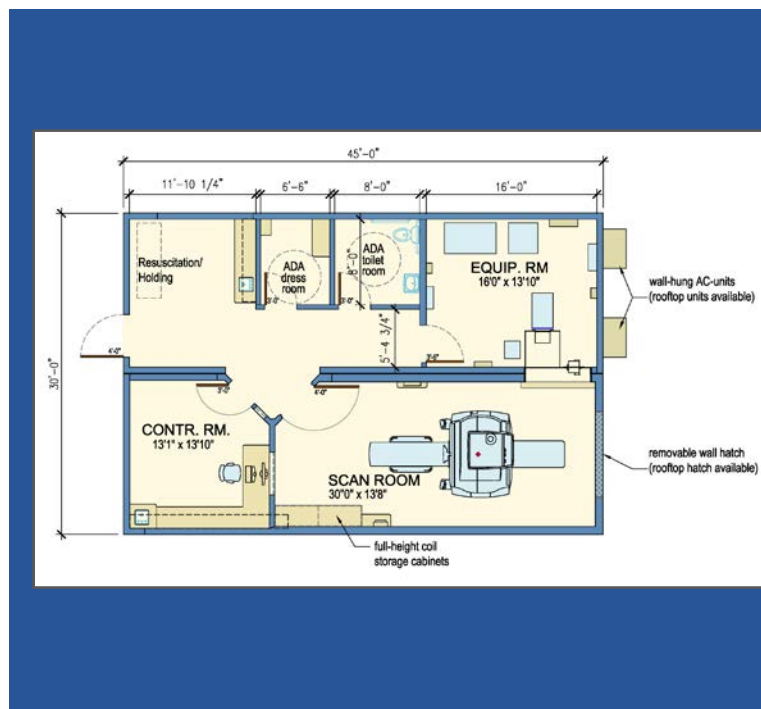

ADDITIONAL FEATURES & OPTIONS

- SPEED - deliver a building for MRI imaging services in the shortest time-frame possible
- SIMPLICITY - sitework, building installation, and building removal
- COST CONTAINMENT - project planning expenses and site construction expenditures
- COMPLIANCE with federal, state, local and health department codes
- INSTITUTIONAL CODE building for hospital inpatient use
- Tested superior IMAGING QUALITY in a TEMPORARY or PERMANENT Design



Find out more about PDC's
Relocatable Diagnostic
Imaging Suites here:



700 Walnut Ridge Dr., Hartland, WI 53029 • pdcbiz.com