



# ESSENTIAL WIRELESS IN-BORE VIEWING VIDEO DISPLAY



## TO POWER ESSENTIAL WIRELESS IN-BORE VIEWING VIDEO DISPLAY (WIRELESS VIDEO DISPLAY) ON/OFF:

- Press power button on top of Wireless Video Display to power ON and OFF
- Power button illuminates when powered ON
- Power OFF and charging recommended nightly

## TO CHARGE:

1. Plug charging cable into wall outlet
2. Charging can take place during an MRI scan
3. With the Wireless Video Display powered OFF, a full charge takes about 8 hours
4. Charging nightly with Wireless Video Display powered OFF is recommended
5. For best battery life, discharging to 50% before recharging recommended
6. See indicators below for charge status

## WIRELESS LED INDICATORS:

- 3 Lit **GREEN** LEDs = Fully charged & charger is connected
- 2 Lit **GREEN** LEDs = Fully charged & charger. Between 12 & 6 hours of battery life
- 1 Lit **GREEN** LED = Half charge. Between 6 & 1 hours of battery life
- 1 Lit **RED** LED = Battery is depleted and requires recharge. Monitor will power OFF

SCAN FOR WIRELESS VIDEO DISPLAY  
TRAINING & MARKETING RESOURCES



## FOR SUPPORT OR QUESTIONS CONTACT:

pdcbiz.com • 262-369-1929 • [techsupport@pdcbiz.com](mailto:techsupport@pdcbiz.com)



# ESSENTIAL WIRELESS IN-BORE VIEWING VIDEO DISPLAY

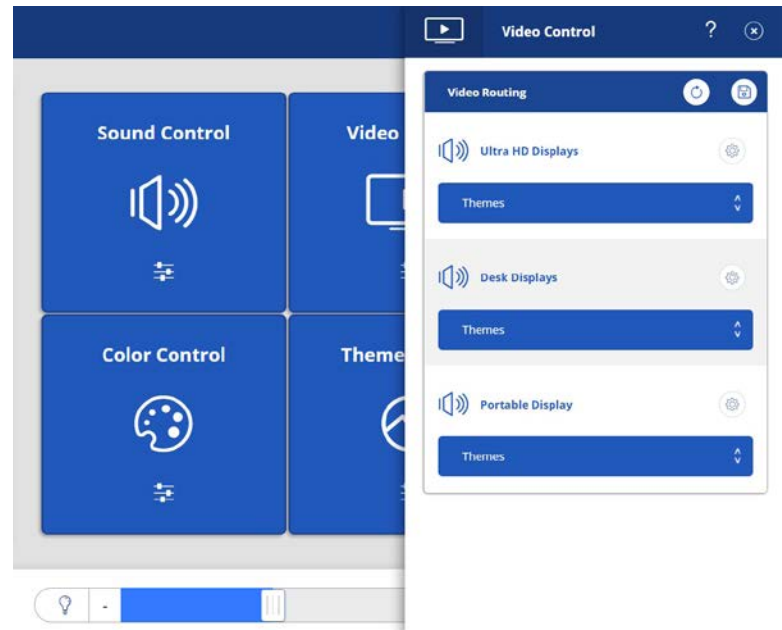

## POSITIONING:

- When possible, keep Wireless Video Display 3 feet from magnet
- For in-bore viewing, position Wireless Video Display behind magnet bore, at least 3 feet from bore
- To adjust the height of Wireless Video Display, turn the **BLACK** lever on the stand, closest to display, to the noted unlocked position, adjust height and return lever to locked position
- Lock wheels in place by pressing “down” on wheel levers. Lift levers “up” to unlock

## TROUBLESHOOTING:

- If Display says, “Waiting to Connect”: Move it 4+ ft from magnet & power off. Unplug & re-plug transmitter & transmitter-receiver. Power back on Display
- If Display says, “No Input”: Ensure video content is selected & if applicable, playing. Ensure HDMI connections are secure. Move Display 4+ ft from magnet, power off Display using Display button, wait 30 seconds, & power Display back on. Unplug & re-plug Audio Video Box

SCAN FOR WIRELESS VIDEO DISPLAY  
TRAINING & MARKETING RESOURCES



For **Training** needs, please contact **Jessica** at [jessica@pdcbiz.com](mailto:jessica@pdcbiz.com)

[pdcbiz.com](http://pdcbiz.com) • 262-369-1929 • [techsupport@pdcbiz.com](mailto:techsupport@pdcbiz.com) 02/21/2025 R1