

CARING LIGHTING + CAMERA APP

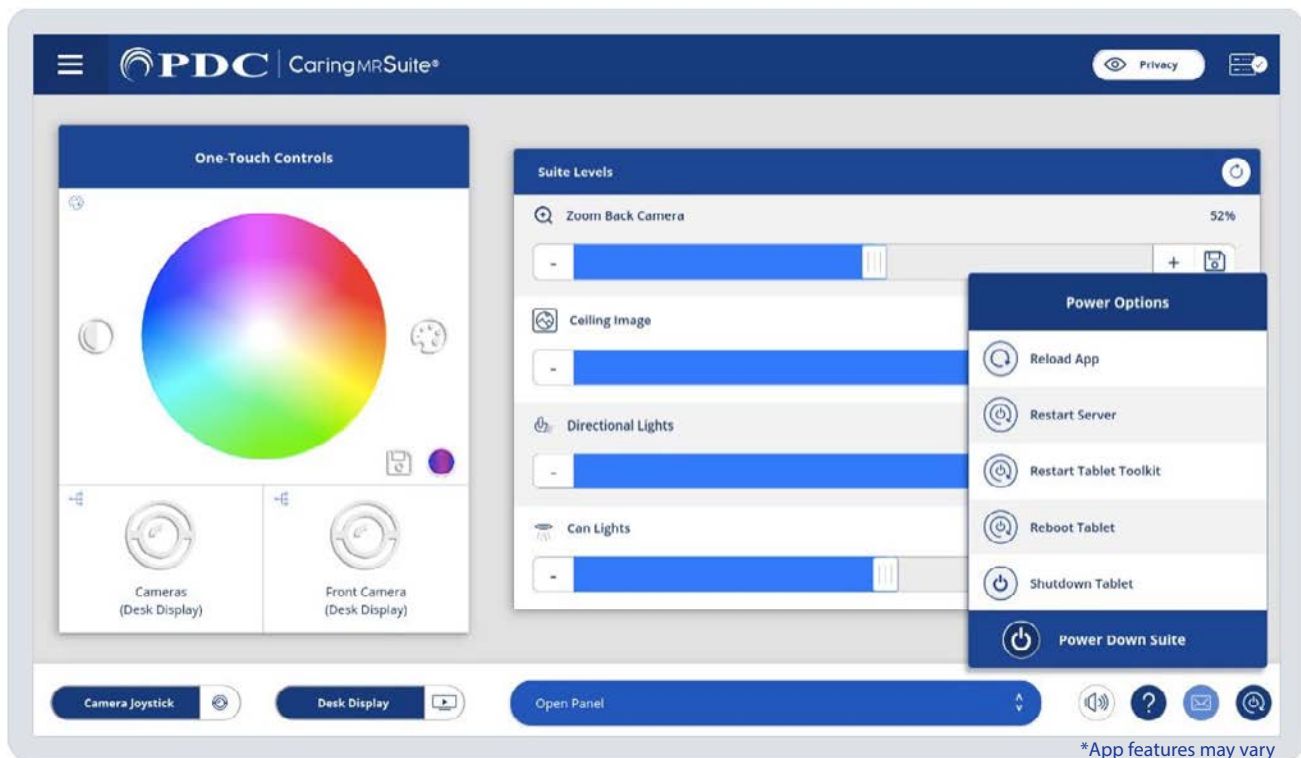

*App features may vary

- **Tablet Power:** Located behind right side of tablet screen. No need to power off tablet
- **Power + Troubleshooting:** Tap to wake tablet if sleeping, & tap **Power icon** at bottom right. Tap desired power option. For App issues, tap **Refresh App** or **Reload App**. For connection issues, tap **Reboot Tablet**. For other issues, tap **Restart Server**
- **Menu Icon:** Located at top left of PDC for App navigation. Levels Portal is the main view. Admin Portal is used to customize suite
- **One Touch Controls:** At left, tap **Color Wheel** for desired color & a camera option to show on desk display. **Cameras** will display all cameras
- **Suite Levels:** Tap or drag sliders to adjust respective lighting intensity & camera zoom
- **Lighting Color Presets:** Tap **Pallet icon** beside Color Wheel to open side bar. Tap to select a color & tap **Save as Preset**. Tap to select a preset from side bar bottom or App bottom
- **Camera Joystick:** Tap to adjust camera pan & tilt. Use circle & or arrows to adjust
- **Desk Display:** Tap for more Desk Display options. See P2 to add this option
- **Open Panel:** Allows access to additional white light options. Tap bar & tap "Light Control." See P2 to add option
- **Rack + Checkmark Icon:** Located at top right, this signifies your App is connected. If icon is red, first tap **Power icon**, bottom right, & tap **Restart Tablet Toolkit** or **Reboot Tablet**
- **Mail Icon at Bottom Right:** Displays App messages for troubleshooting purposes

For **Training** needs, please contact **Jessica** at jessica@pdcbiz.com

CUSTOMIZING YOUR APP

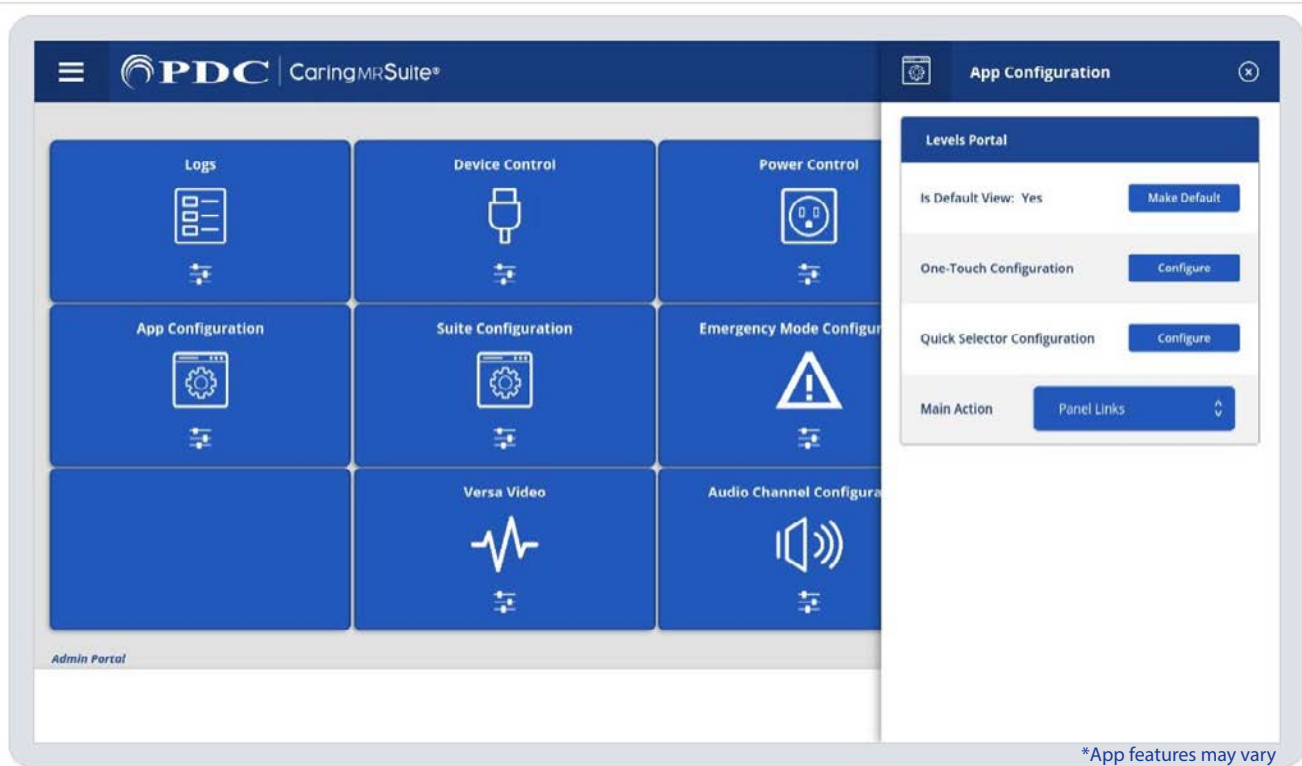

*App features may vary

- **To Add Options & Customize One-Touch Controls:** Tap **3-bar Menu icon** at top left, & tap **Admin Portal**. Enter: **8675309**. Tap blue **App Configuration** box
 - **To Add Open Panel or Color Presets:** Tap blue bar beside **Main Action** & tap to choose desired option
 - **To Add Desk Display Quick Selector:** Tap **Configure** beside **Quick Selector Configuration**. At right, tap **AV Routes** & tap the **(+)** beside **Desk Display**
 - **To Customize One-Touch Controls:** Tap **Configure** beside **One-Touch Configuration**, tap **Remove a Control** at top & tap to remove unwanted option(s). Add options at right by tapping the **(+)** beside the option. Tap **Save Configuration** at top once complete
- **To Create Color Changing Gradient Presets:** Tap **Half Filled Circle icon** to left of Color Wheel. Tap to choose from Preset Colors at right - or tap **[+]** icon to bring up Color Wheel for selection. Add as many colors as you wish, & tap & drag color squares to adjust timing between colors. Below color squares, tap the **Pencil/Edit** option to adjust the time of your Gradient. Beside **Gradient Builder** at top, tap **Play icon** to Preview & Save icon to save to your Presets. Tap **Circular Arrow icon** to refresh



SCAN FOR VIDEO TUTORIAL & OTHER RESOURCES