



Relocatable MR Cassette® Mini Clinics

Want the speed, simplicity, flexibility and beauty of the Cassette® – but need more space? Consider the Cassette® Mini Clinic, designed to your specifications.

You choose the size and design – we'll deliver your relocatable Mini Clinic to have you serving patients in the shortest time-frame possible.

Plus, if plans change – so can your Mini Clinic.

Begin your architectural planning process today for your permanent building. Take delivery of your own "fixed site" MRI system in a spacious building. Simply "transplant" your MRI system into your completed construction and redeploy or sell the Cassette® building. How more "lean" and cost effective can it be to bring tomorrow's MRI technology to your patients today!

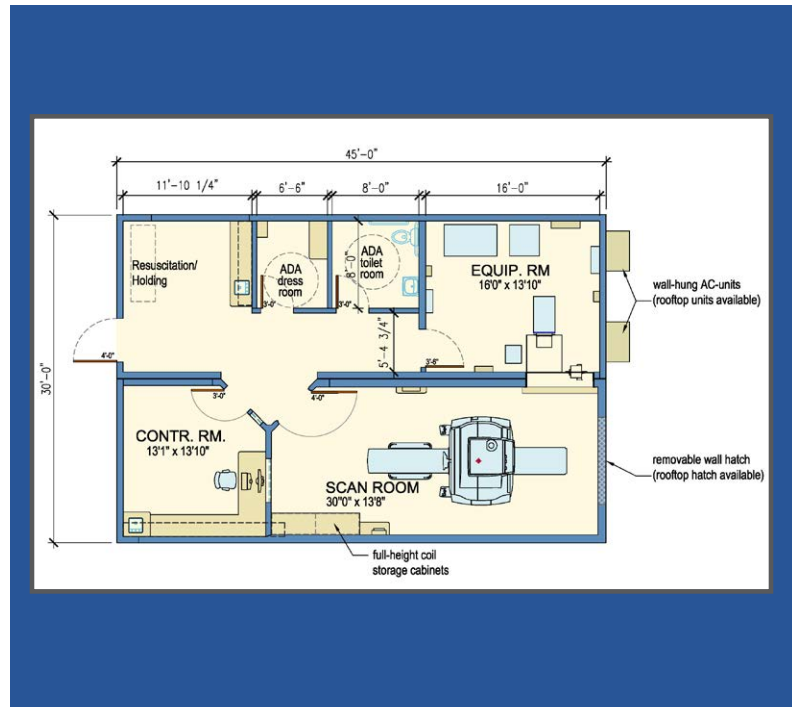

ADDITIONAL FEATURES & OPTIONS

- SPEED - deliver a building for MRI imaging services in the shortest time-frame possible
- SIMPLICITY - sitework, building installation, and building removal
- COST CONTAINMENT - project planning expenses and site construction expenditures
- COMPLIANCE with federal, state, local and health department codes
- INSTITUTIONAL CODE building for hospital inpatient use
- Tested superior IMAGING QUALITY in a TEMPORARY or PERMANENT Design



Find out more about PDC's Relocatable Diagnostic Imaging Suites here:



700 Walnut Ridge Dr., Hartland, WI 53029 • pdcbiz.com